



GRUPPO SOSTA

Gruppo Sosta - acciaio inox AISI 316L
Belay Station - Stainless steel AISI 316L
Desquelgue - inoxidable AISI 316L
Ensemble - inox AISI 316 L

Conformità **EN 795: 2012**
EN 959: 2007
 UIAA

Precauzioni per l'uso Precautions for use
Precauciones de uso Précautions d'emploi

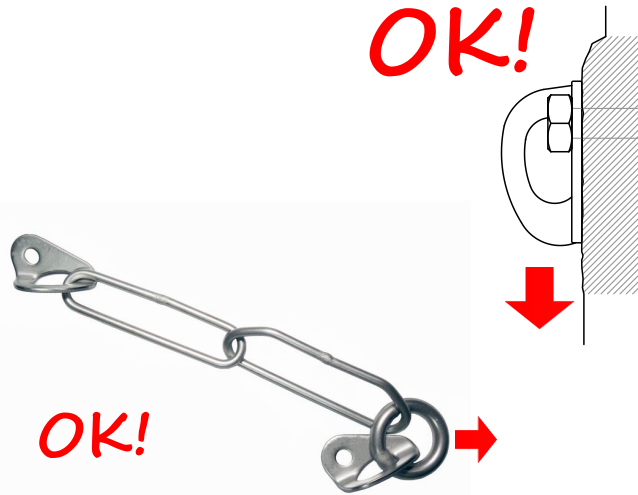
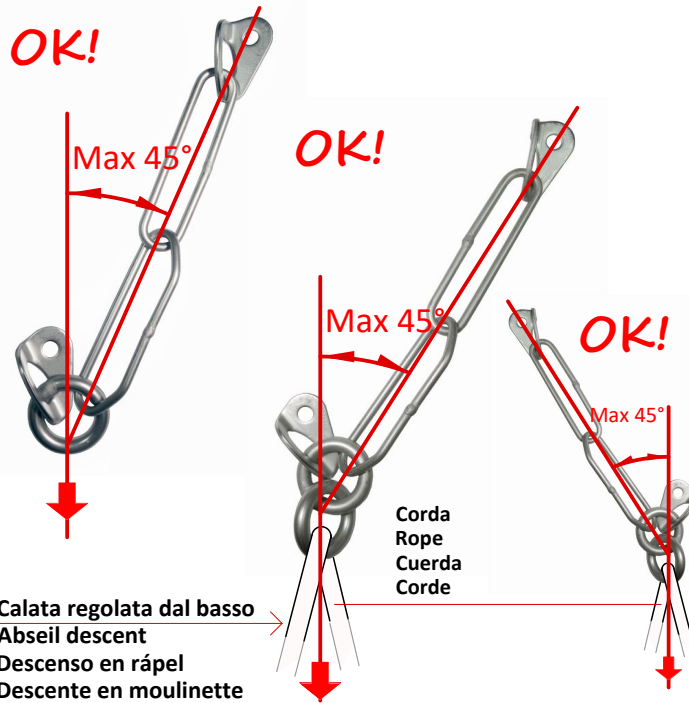

**WARNING,
DANGER!!!**

